

Ford Ranger WildTrak 2022+

GearForce Cantilever Rack



bit.ly/3E50Zsk



Despatch List:

ID#	DESCRIPTION	IMAGE	QTY
1	Large Packer (PRT-007024-04)		2X
2	Small Packer (PRT-007024-05)		4X
3	M6 x 35mm Hex Bolt		4X
4	M6 x 25mm Hex Bolt		4X
5	M6 Spring Washer		8X
6	M8 x 20mm Btn Head Bolt (Black)		16X
7	M8 Nyloc Nut		16X
8	Thread Plate (PRT-007047)		8X
9	PRT-007149		2X
10	PRT-007150		2X
11	M6 x 16mm Btn Head Bolt (Black)		8X

We recommend to remove the roof racks on the Wildtrak if you intend to carry a large load on the cantilever.
If you do not intent to, skip to step 7

1



Remove the plastic cap on the roof rack using a small screwdriver.

2



Remove the bolt using a T40 Torx bit.

Important Note: Go slow and be very careful not to strip the recessed nut within.

3



Slide the retainer plate backwards to release the roof rack

4



Remove the bolts holding the base plate down

5

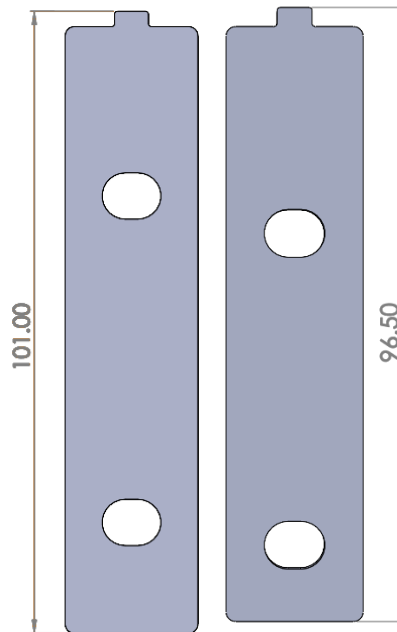

Install the replacement capping plates **[9],[10]**

The longer plates **[9]** are installed on the front and the shorter ones **[10]** on the rear of each rack.

6



Screw down each plate using the following fastener:

[11] 8x M6x16mm Btn Head Bolt (Black).

Ensure you have a GearForce Fit Kit installed when using GearForce Products.
If you have a GearForce Platform, skip to step **10**

7



Slide 4x of the provided thread plates **[8]** in from the front of each track

Slide the thread plates using an Allen key to have a pair at the rear and pair up the front of each track as shown.

8



Long side

Place down a provided small packer plate **[2]** over each set of thread plates. Make sure to line the thread plates up with the slots in the packer.

Ensure the longer side faces in towards the tub as shown.

9



Place a large plastic packer **[1]** only on top of the **front** packer plates (the two closest to the sailplane)

10

TUB PLATFORM ONLY

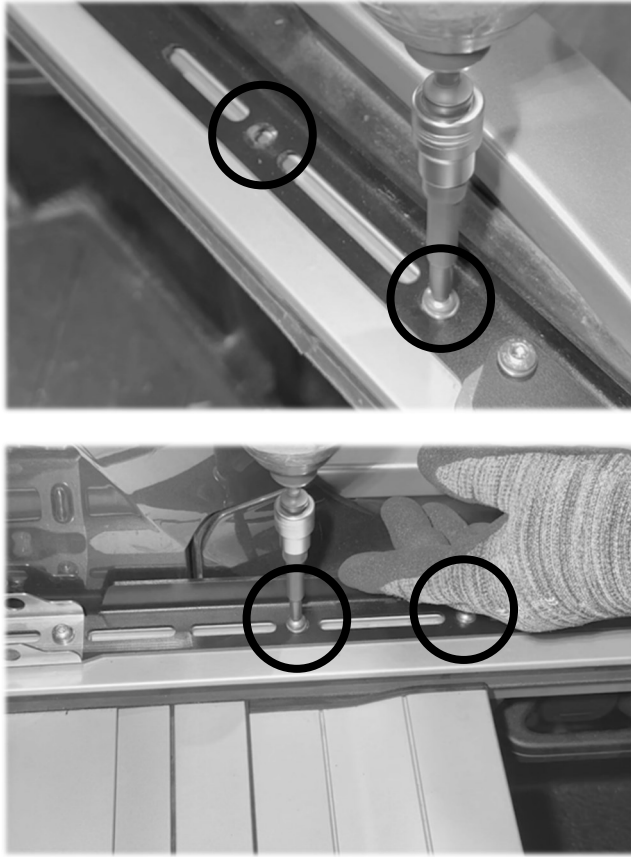

If you have a GearForce Tub Platform installed, remove the 4 indicated bolts on each of the base brackets.

Make sure to leave the thread plates in the same position as this is where the cantilever bolts to.

11

TUB PLATFORM ONLY



If you have a Tub Platform installed, place a large plastic packer [1] over the two holes at the front of each bracket

12



Place a Cantilever leg over each set of thread plates. 2x of the left leg will go on the left side. 2x of the right leg will go on the right side.

The legs should be positioned so that they are all naturally leaning forward as shown.

13



Loosely bolt down all the cantilever legs using the following fasteners:

- [3]** 4x M6 x 35 Hex bolt
- [4]** 4x M6 x 25 Hex bolt
- [5]** 8x M6 Spring Washer

Important Note: Use the larger 35mm bolts on the front pair of legs.

14



Sit the Cantilever Rack on top of the legs. You may need to reposition the legs to line up with the sockets on the rack.

Tip: Get the front legs in first before the rear

15

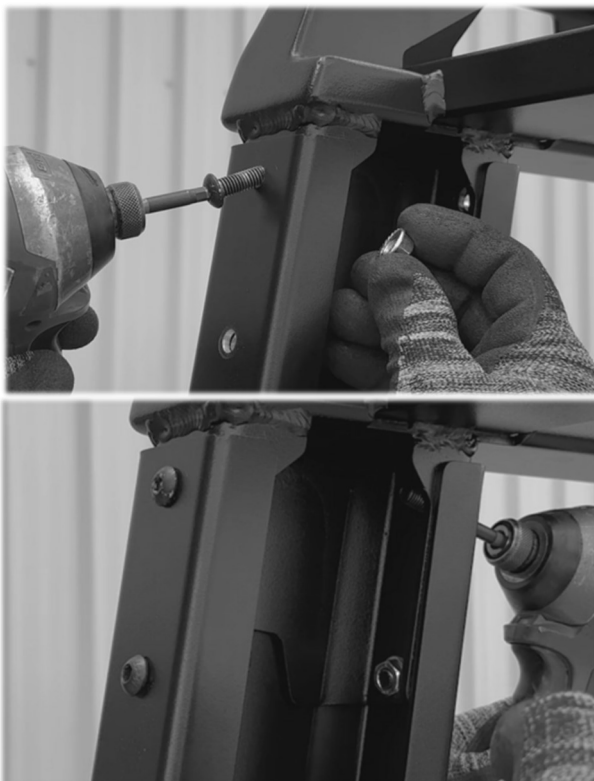

Bolt the Cantilever Rack to the legs using the following fasteners:

- [6]** 16x M8 x 20 Btn Bolt
- [7]** 16x M8 Nyloc Nut

16



Tighten all the leg bolts now that the Cantilever is in its final position.

17

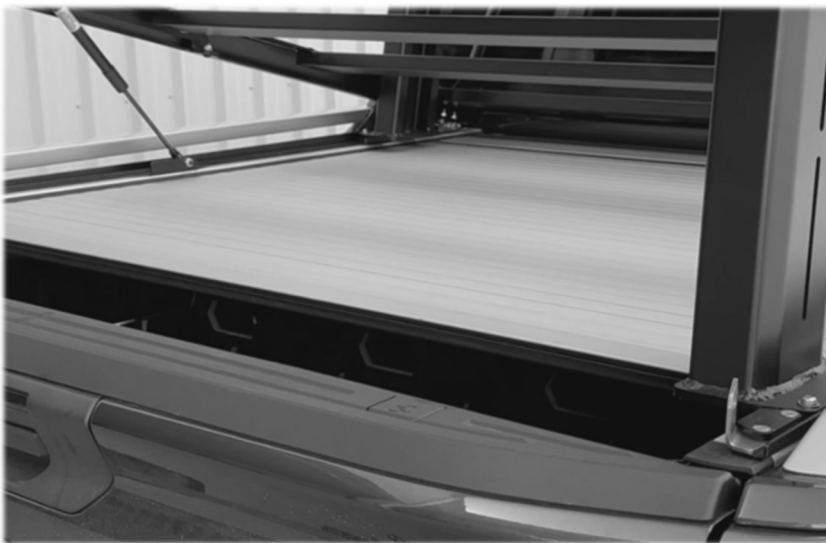

Check that your WildTrak roller shutter lid still opens and closes completely.

If the lid does not close all the way, loosen the bolts fixing the Cantilever rack in place and retighten with the lid closed. If problems persist, contact Utemaster for assistance

Your GearForce Cantilever Rack is now fully fitted and ready to use.
Thanks again for choosing Utemaster and don't forget to keep checking our website for our latest innovations!