

Ford Ranger 2022+ LLX-FRC2SBGA-AUB Sports Bar Load-Lid™



Installation
video

<https://cutt.ly/6NjZgdw>



Despatch List:

ID#	DESCRIPTION	IMAGE	QTY
1	PRT-005957-01 <i>(with sponge gaskets installed)</i>		1x
2	PRT-005962R PRT-005962L		1x 1x
3	PRT-005465R PRT-005465L		1x 1x
4	PRT-005480-03L PRT-005480-03R		1x 1x
5	PRT-005961		2x
6	PRT-005963		2x
7	SS0610-5M		1x

ID#	DESCRIPTION	IMAGE	QTY
8	PRT-004286		4x
9	M8 x 16mm Btn Bolt (Black)		6x
10	M8 x 25mm Btn Bolt (Black)		18x
11	M8 Spring Washer		18x
12	M8 Medium Washer		14x
13	M8 Fender Washer		4x
14	M8 Nyloc Nut		14x
15	M6 x 20mm Btn Bolt		2x



Any steps marked with the alert symbol are critical steps for removing or refitting existing vehicle bolts. These bolts have a thread locking glue, and can become jammed and snap when force is applied. Recommended procedure is to use a heat induction tool to loosen the bolts, alternatively use Förch Black Magic to lubricate the thread. Gently work the bolt backwards and forwards in the thread using hand tools to 'crack' the thread locking glue. Slowly extract the bolt using hand tools. Take equal care when refitting the bolts, ensure the bolt is clean and the thread is lubricated. Bolts may require heating to soften the glue before refitting. **DO NOT FORCE THE BOLT IF JAMMED.** Take the vehicle to a specialist if the problem persists.

1

If the Load-Lid has a Utemaster Sailplane, skip to Step 10

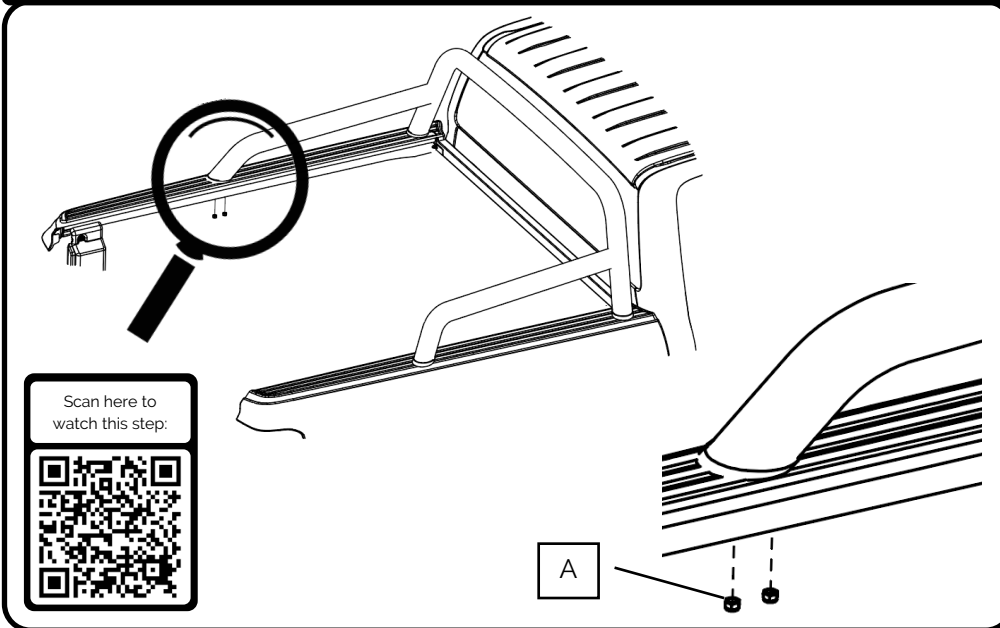

Remove the nuts holding the rear sports bar feet (A).

2

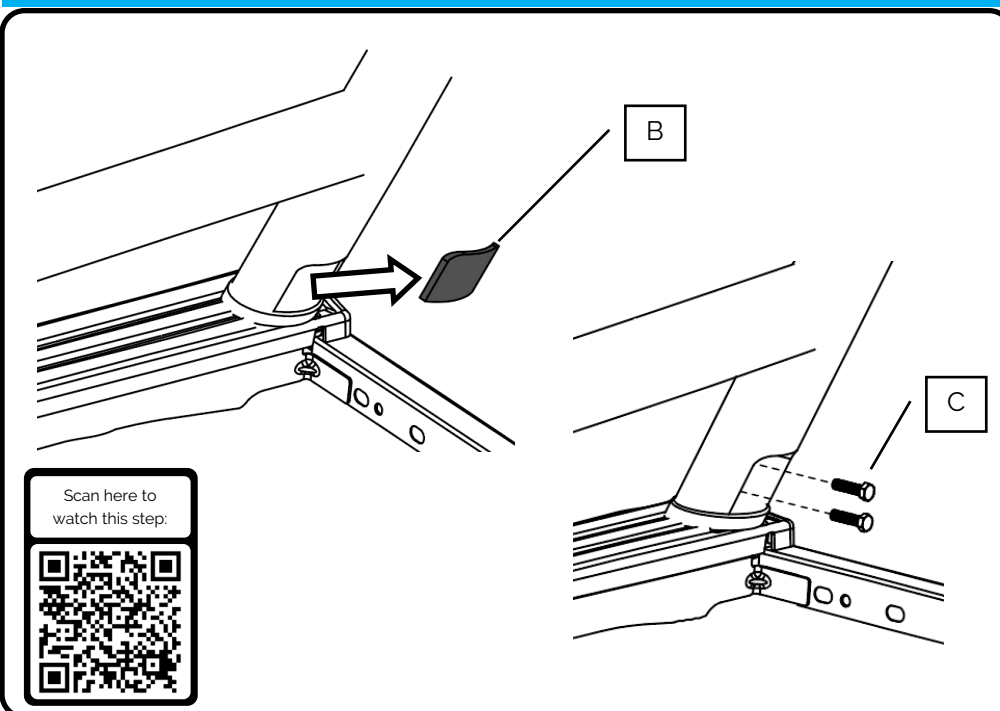

Remove the rubber infill (B) from the front sports bar feet.

Remove the bolts (C) holding the front sports bar feet to the mounting bracket.

3

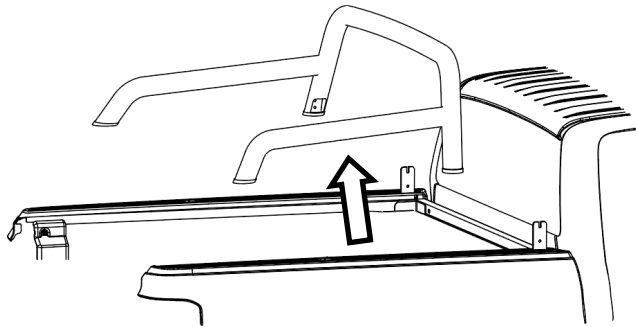

Lift the sports bar off the vehicle.

4

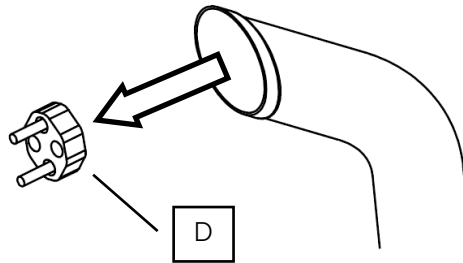

Remove the stud plates (D) from under the rear sports bar feet.

5

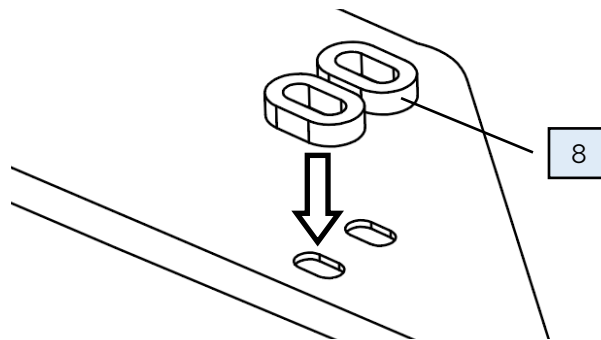

Place the foam washers (8) over the holes in the Load-Lid face plate.

6

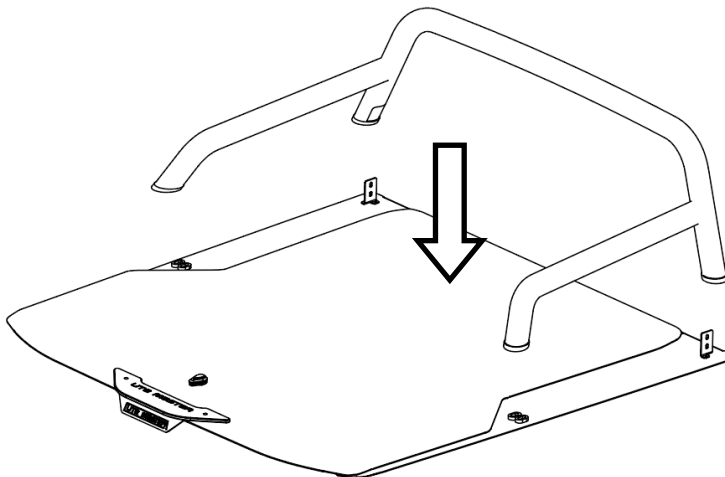

Lift the sports bar onto the Load-Lid.

7

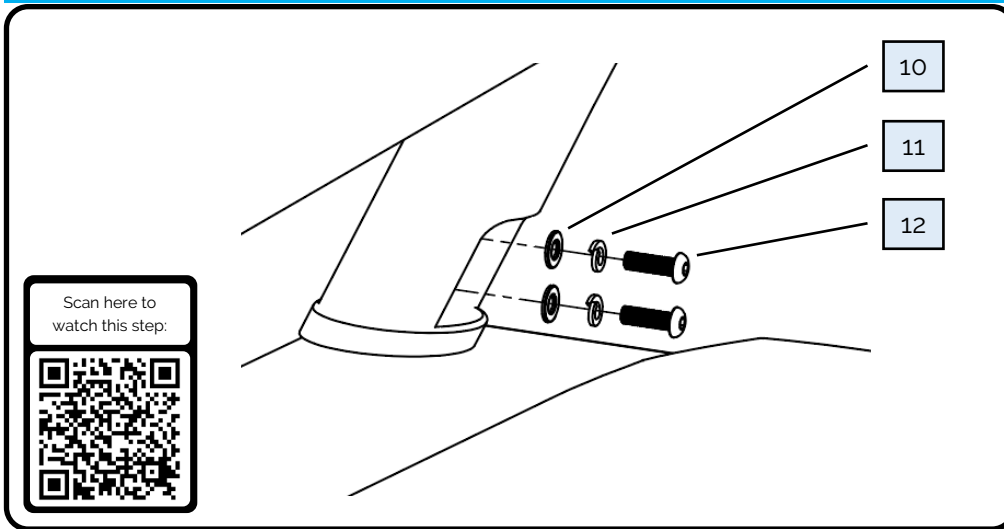

Bolt the sports bar to the front brackets using the following fasteners:

- 10) M8 x 25mm Btn Bolt
- 11) M8 Spring Washer
- 12) M8 Medium Washer

8

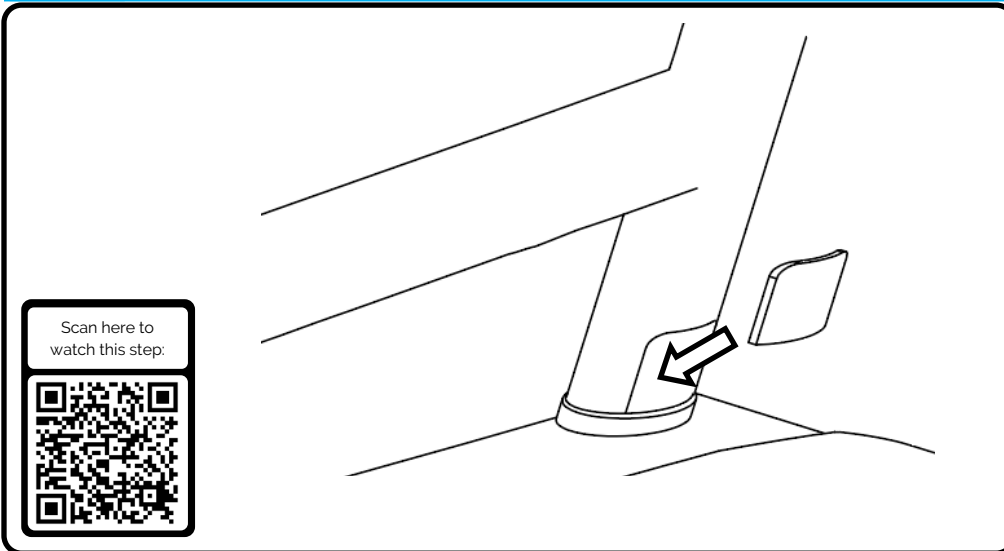

Re-install the rubber infill to the front sports bar feet.

9

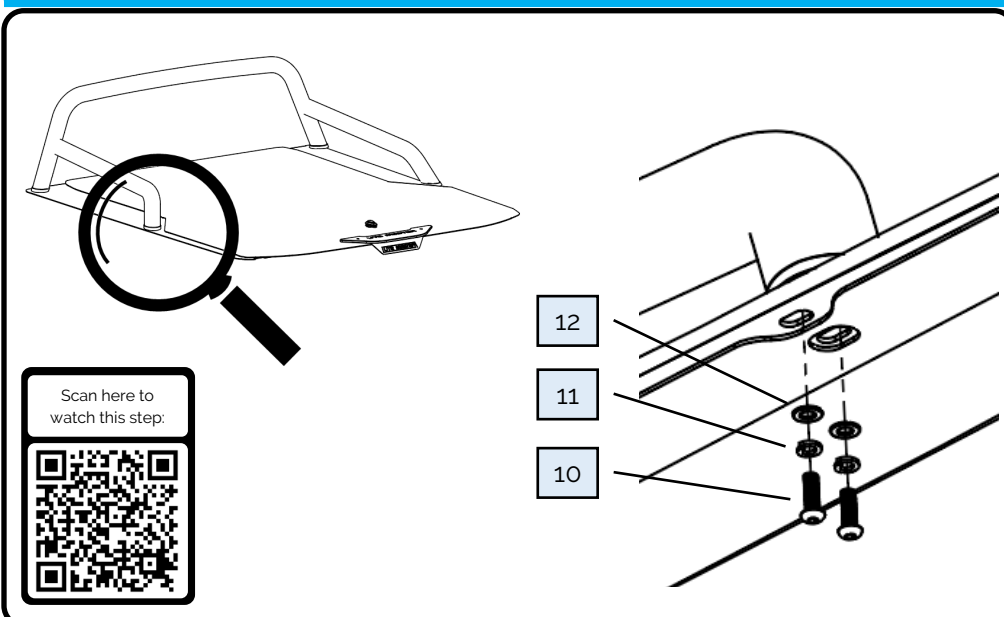

Bolt through the Load-Lid face plate into the rear feet using the following fasteners:

- 10) M8 x 25mm Btn Bolt
- 11) M8 Spring Washer
- 12) M8 Medium Washer

10

Scan here to watch this step:

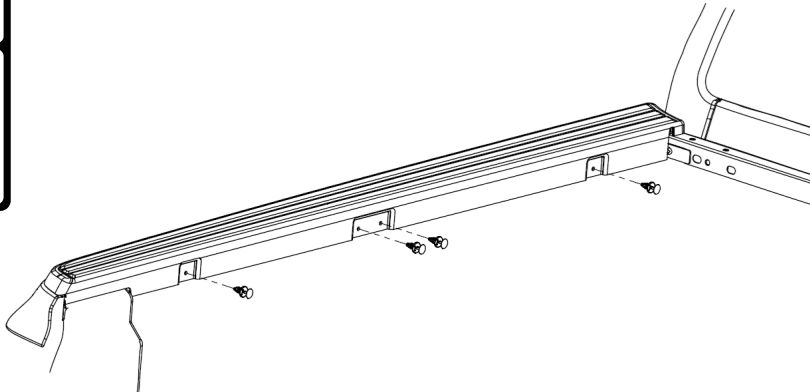

Remove the clips along the side of the plastic caps.

Repeat for both sides.

11

Scan here to watch this step:

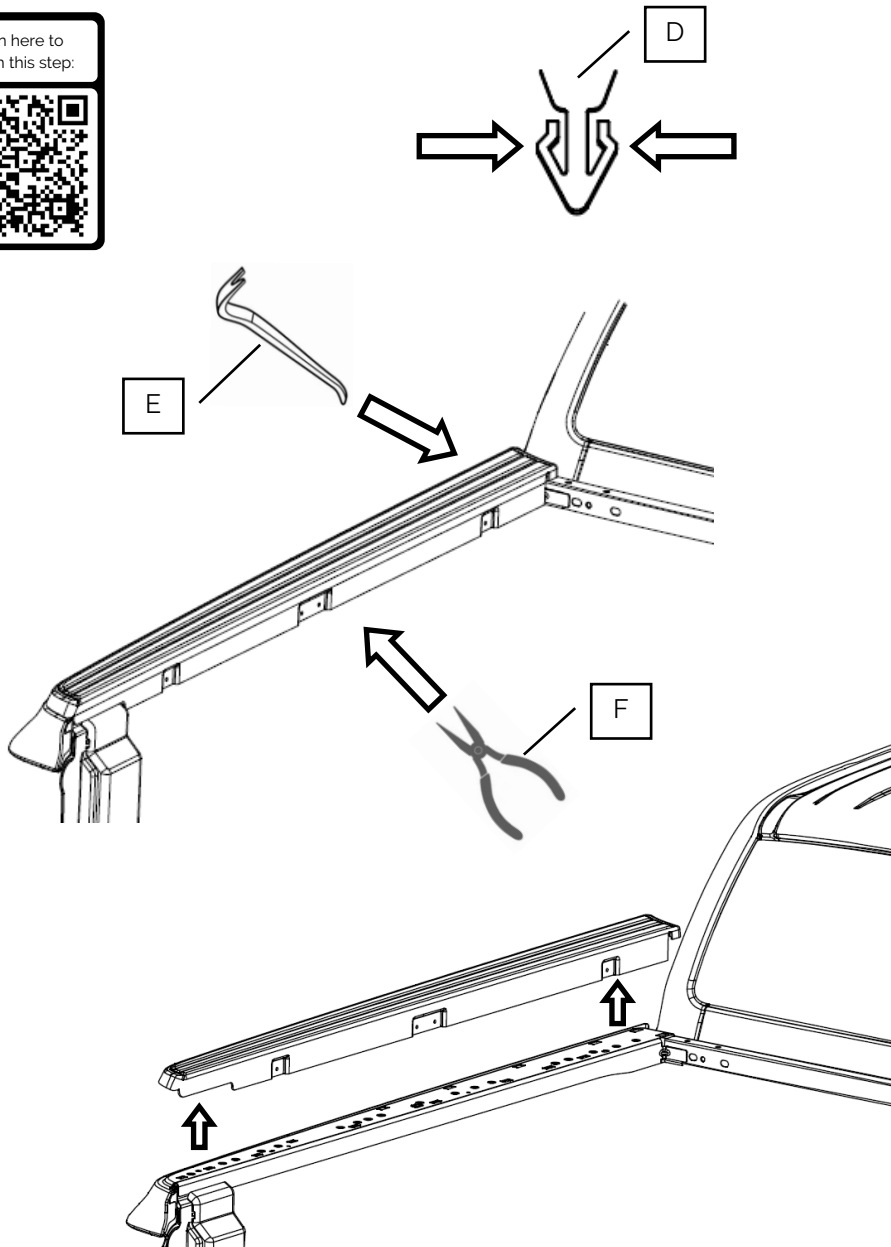

Remove the plastic caps along the sides of the wellside.

The clips need to have at least one side pushed inwards to release the clip (D).

Some clips need a prying tool (E) inserted under the outside of the caps to release the clips, particularly in the front and rear corners, however most of the clips holding the caps in place can be accessed from inside the wellside using pliers (F).

Take care not to damage the clips or the caps, these will be re-installed later.

Repeat for both sides.

12

Scan here to watch this step:

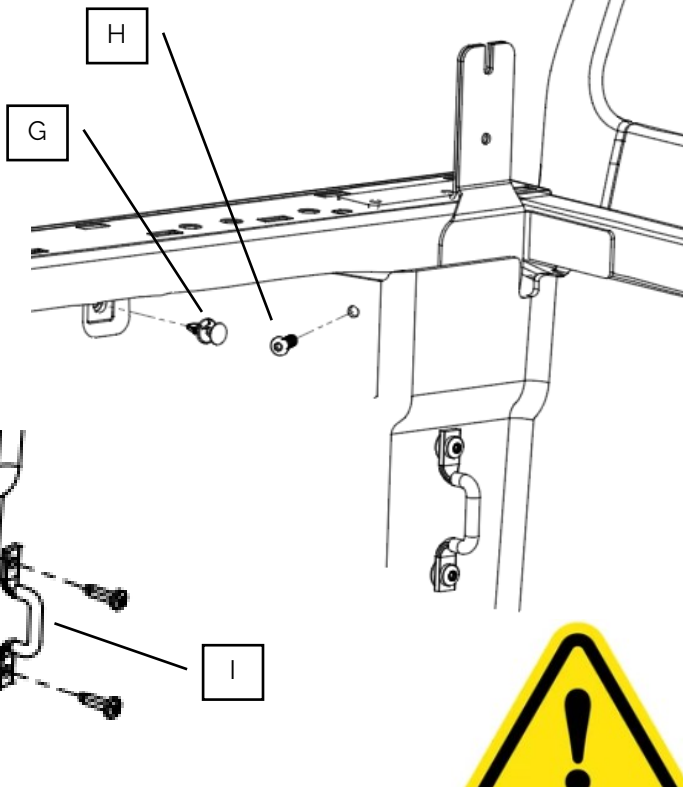

Bolt jamming risk
See Page 2

Remove the front clip (G) and bolt (H) holding the liner in the front corner.

Also remove the hooks from the front corner (I).

Repeat for both sides.

13

If the Load-Lid has a Utemaster Sailplane, skip to Step 14

Scan here to watch this step:

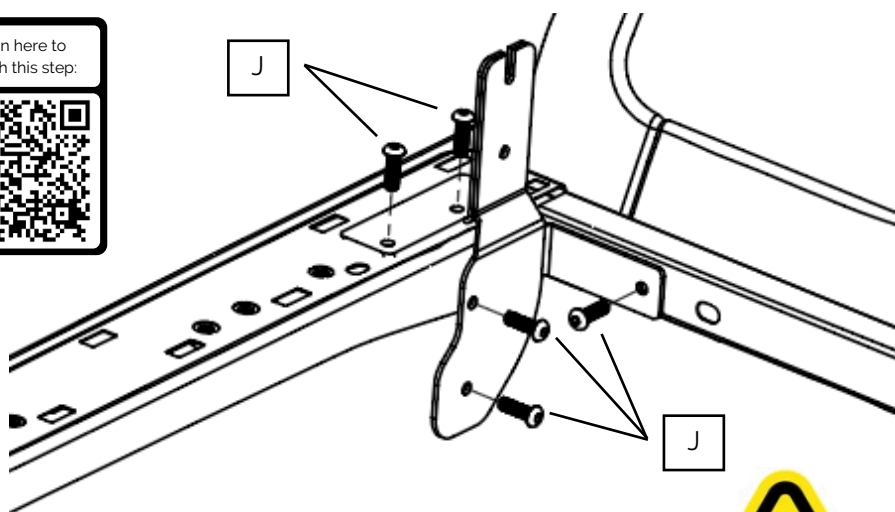

Bolt jamming risk
See Page 2

Remove the bolts (J) holding the sports bar bracket into the front corners.

14

Scan here to watch this step:

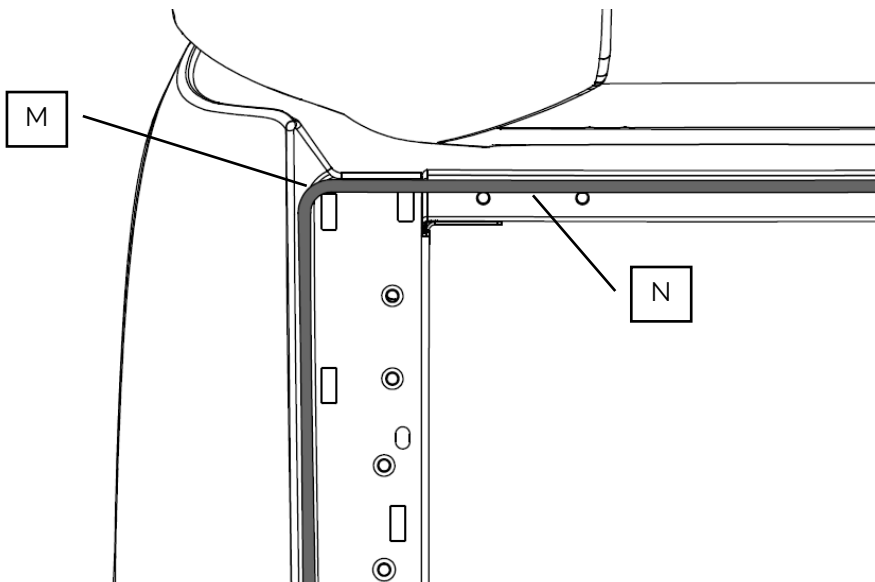
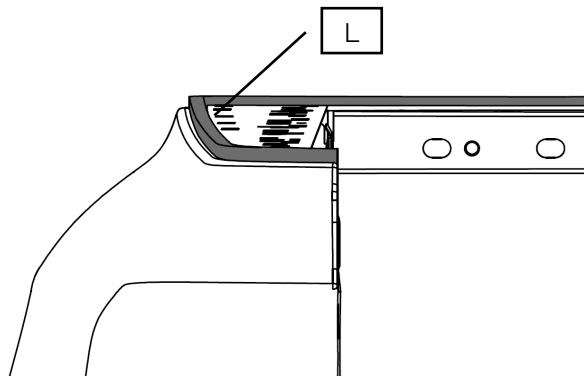
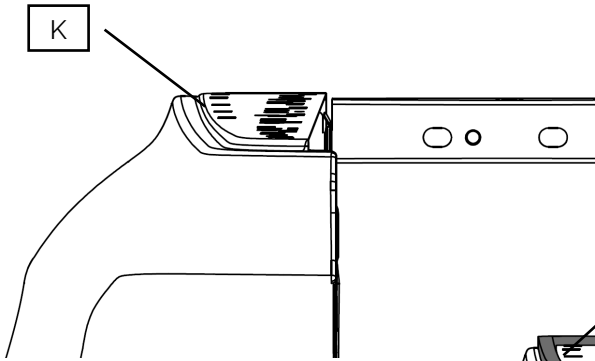
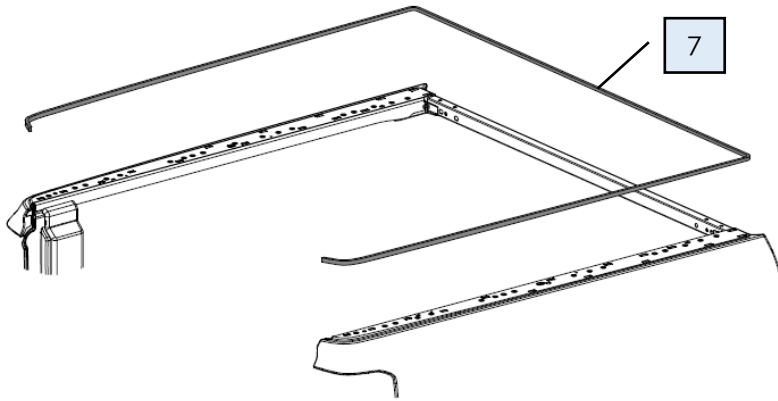

Run the provided sponge seal around the outside of the wellside in a continuous seal, starting at the tailgate on one side and ending at the tailgate on the other side.

Use the raised section (K) along the sides as a guide, the sponge seal should touch the raised section (L).

In the front corners, the sponge seal should turn the corner and run along the front of the wellside (M).

Ensure the sponge seal is in front of the threads (N).

15

Scan here to watch this step:

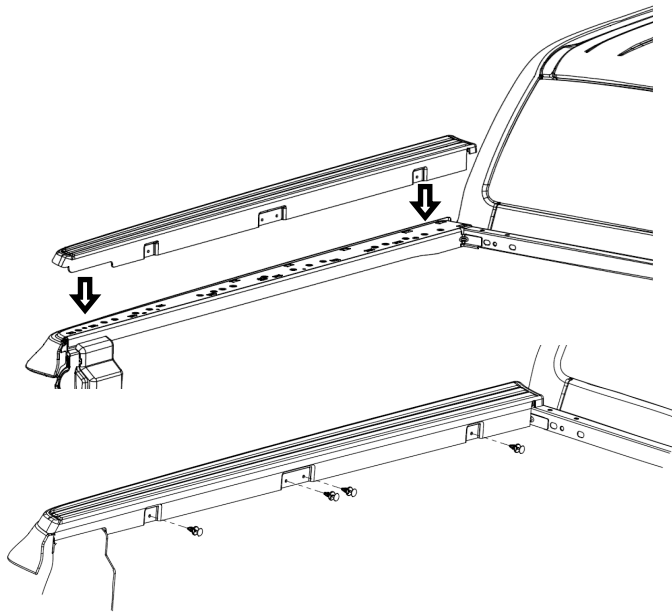

Return the plastic caps to their original position, these should clip back in place.

The caps should compress the sponge seal, but ensure it doesn't bulge out underneath the caps.

Also return the clips to their original position (see Step 10).

Repeat for both sides.

16

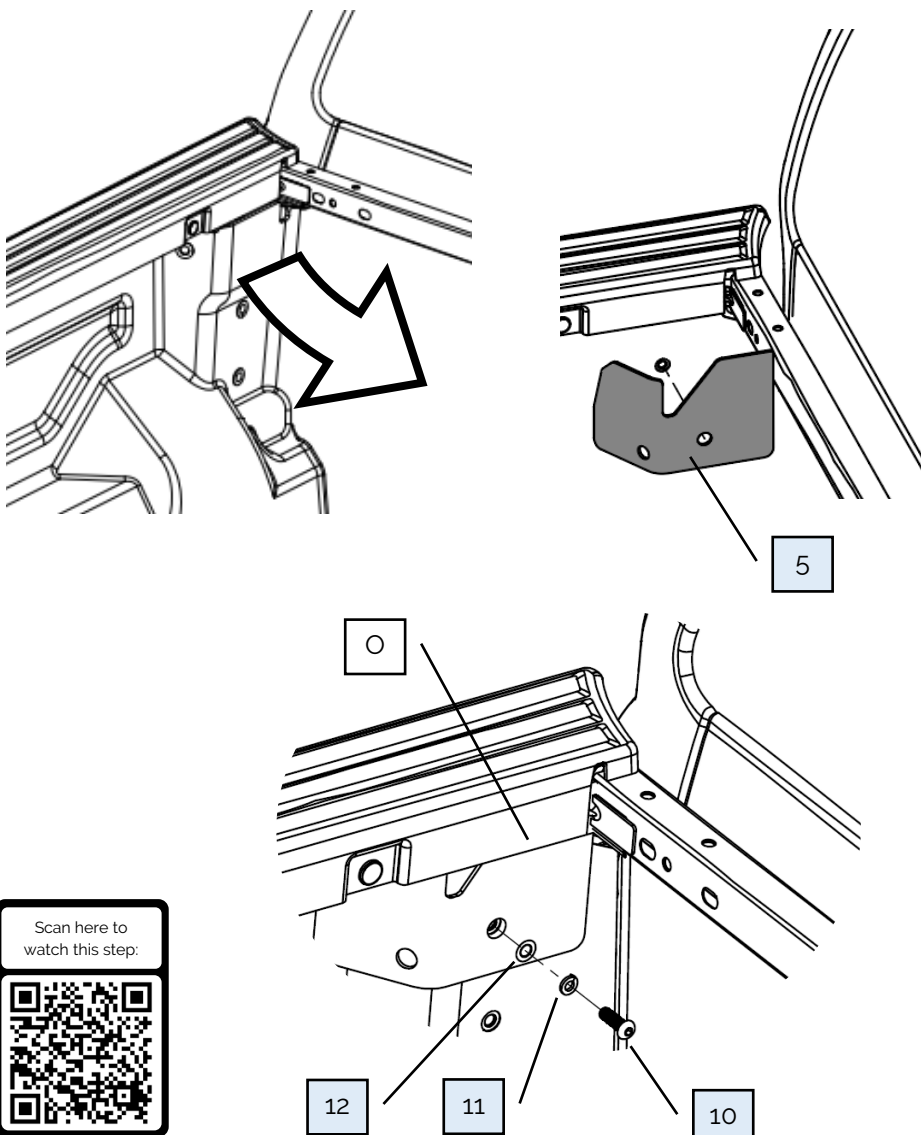

Pull the front corner of the liner away from the wellside wall to give access behind.

Insert the provided rubber gasket. This should sit inside the plastic cap (O). Bolt in place to the front thread using the following fasteners:

- 10) M8 x 25mm Btn Bolt
- 11) M8 Spring Washer
- 12) M8 Medium Washer

Do not overtighten, or the bolt head will pull through the rubber.

Return the liner to its original position, sitting over top of the rubber gasket.

Scan here to watch this step:



17

Scan here to watch this step:

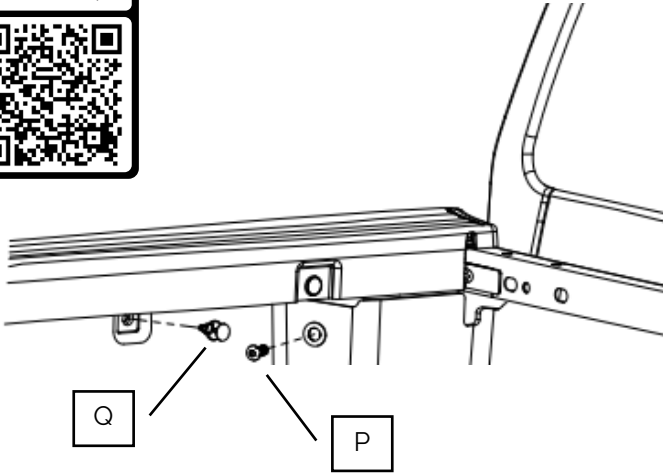

Bolt jamming risk
See Page 2

Return bolt (P) to its original thread, ensure this passes through the hole in the rubber gasket.

Re-insert the plastic liner clip (Q).

Repeat for both sides.

18

Scan here to watch this step:

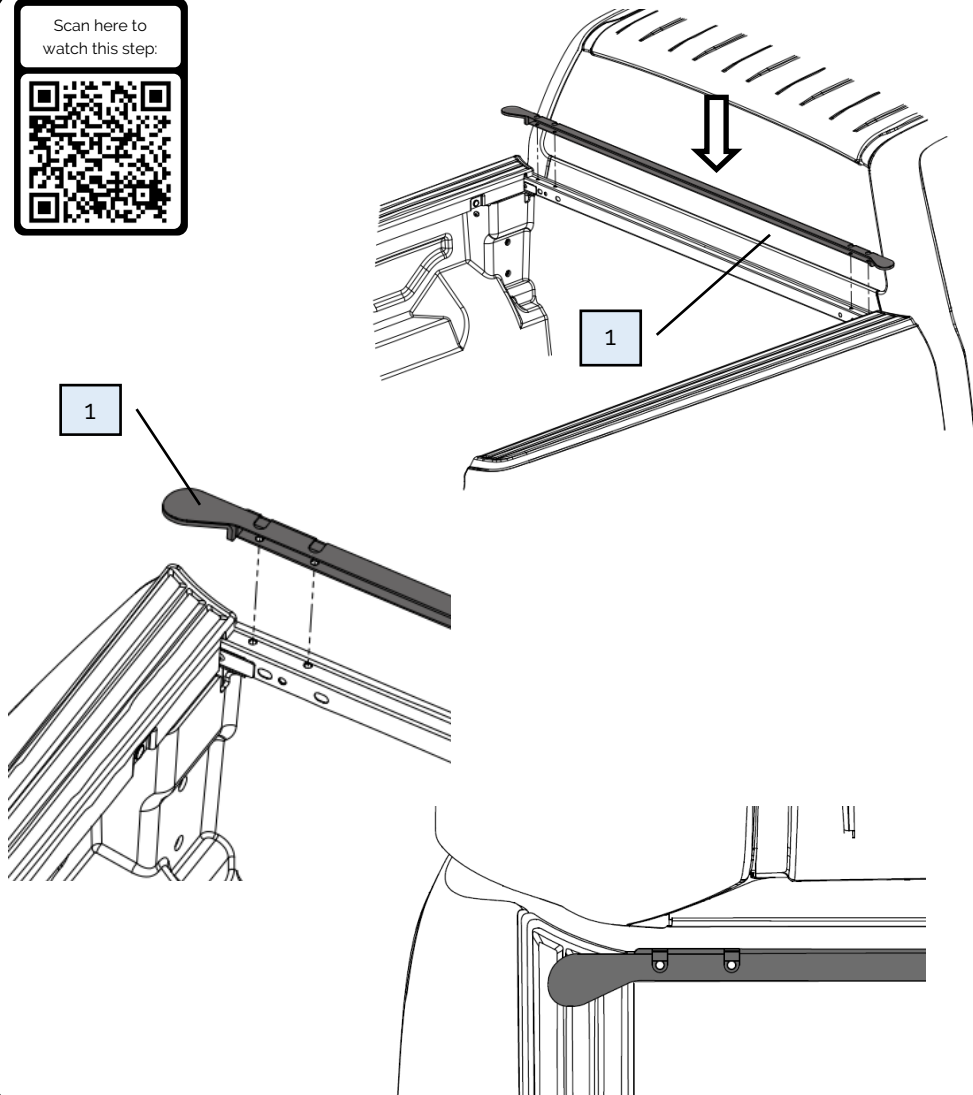

Install the front infill bracket PRT-005957-01 to the front wall of the wellside, between the two plastic caps.

Take care not to scratch the cab when installing.

Ensure the foam compresses tightly and leave no gaps.

19

Scan here to watch this step:

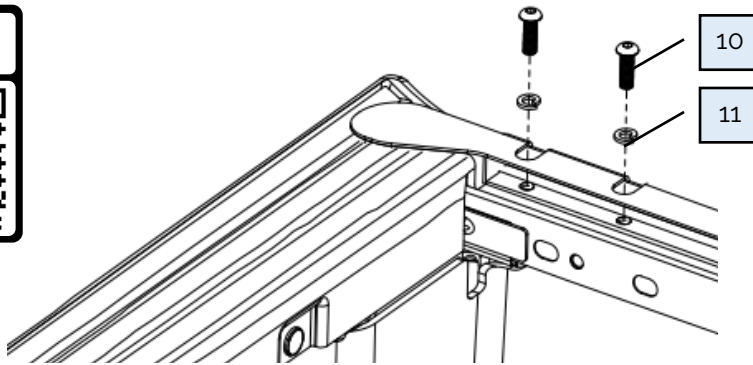

Bolt the infill bracket in place using the following fasteners:

- 10) M8 x 25mm Btn Bolt
- 11) M8 Spring Washer

Repeat for both sides.

20

Scan here to watch this step:

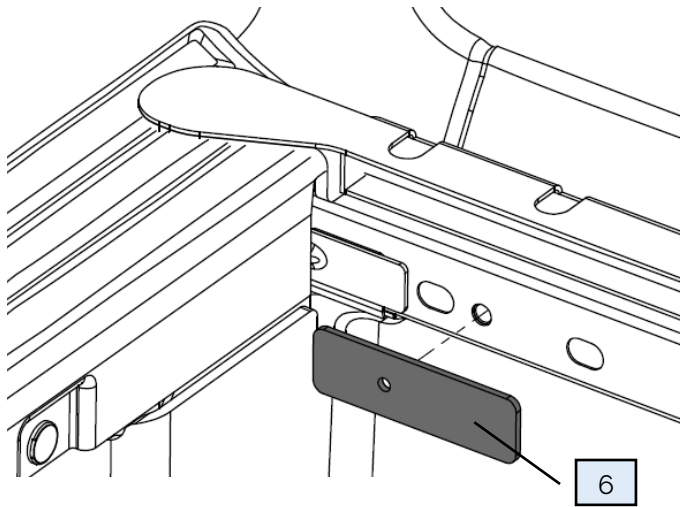

Install PRT-005963 onto the front wall to cover up the open slotted holes.

Ensure the hole in the foam gasket lines up with the thread in the front wall, and that it covers both slotted holes.

Repeat for both sides.

21

Scan here to watch this step:

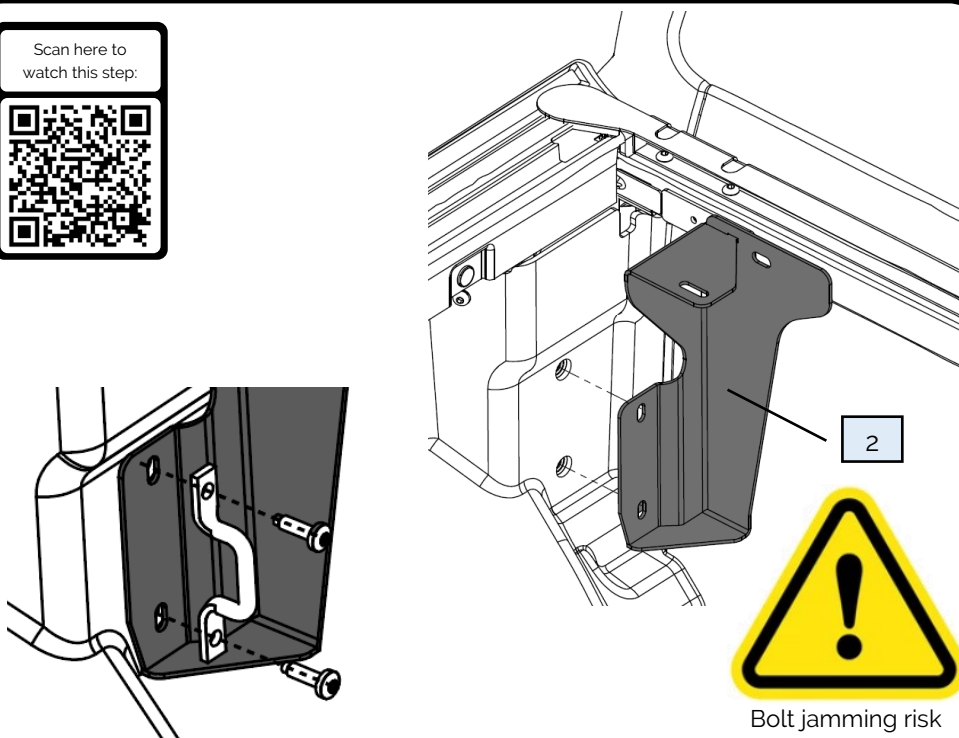

Install the front mounting brackets PRT-005962 into the front corners.

Re-install the hook and bolts through the brackets, leave loose at this stage.

Repeat for both sides.

22

Scan here to watch this step:

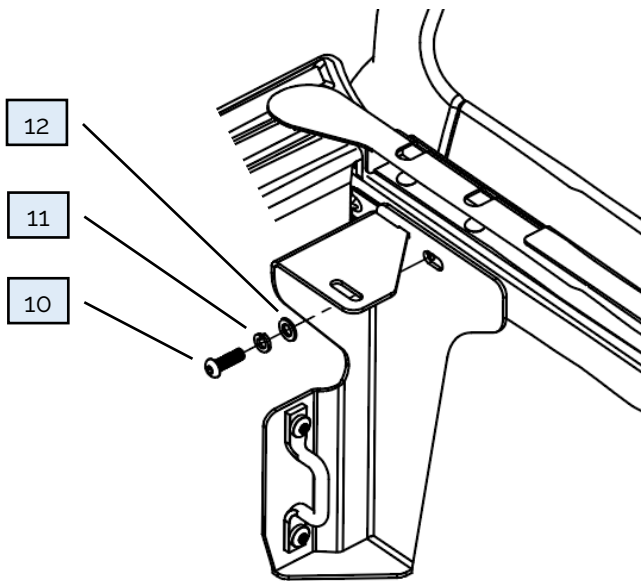

Bolt into the front wall thread using the following fasteners:

- 10) M8 x 25mm Btn Bolt
- 11) M8 Spring Washer
- 12) M8 Medium Washer

Tighten these bolts and the hook bolts (from previous step).

Repeat for opposite side.

23

Scan here to watch this step:

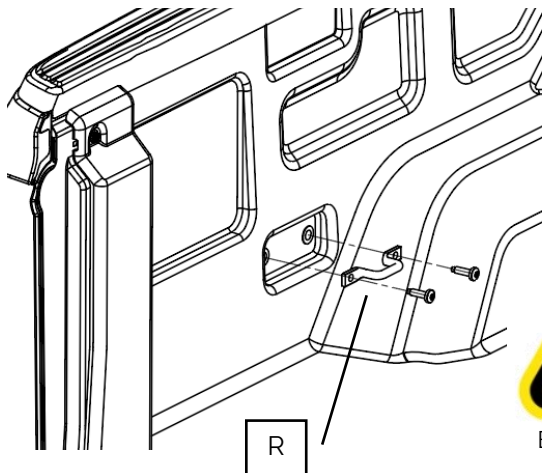

Bolt jamming risk
See Page 2

Remove the centre hooks (R).

Repeat for opposite side.

24

Scan here to watch this step:

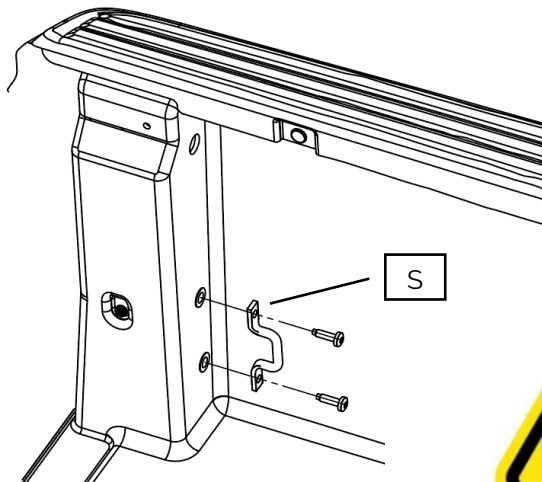

Bolt jamming risk
See Page 2

Remove the hooks from the rear corners (S).

Repeat for opposite side.

25

Scan here to watch this step:

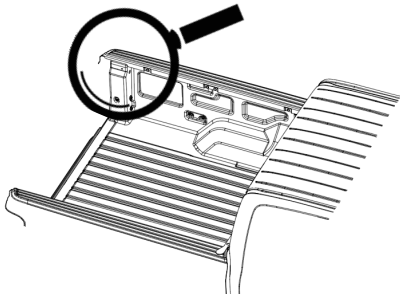
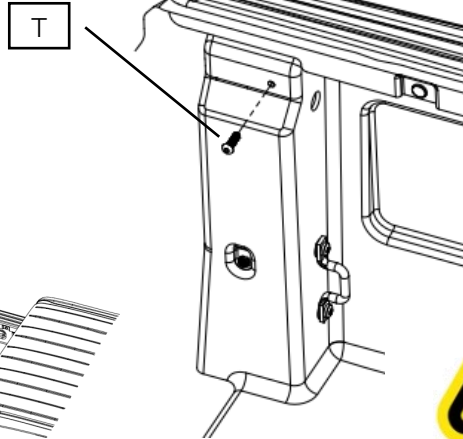

Bolt jamming risk
See Page 2

Remove the existing bolt in the top rear rear corner of the wellside (T).

Keep this bolt for using later.

Repeat for opposite side.

Note: Some vehicles don't have this bolt and can skip this step.

26

Scan here to watch this step:

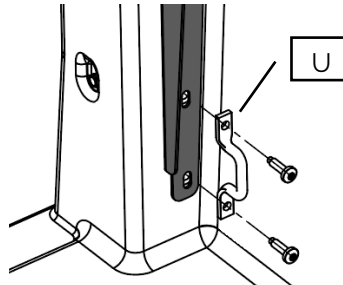
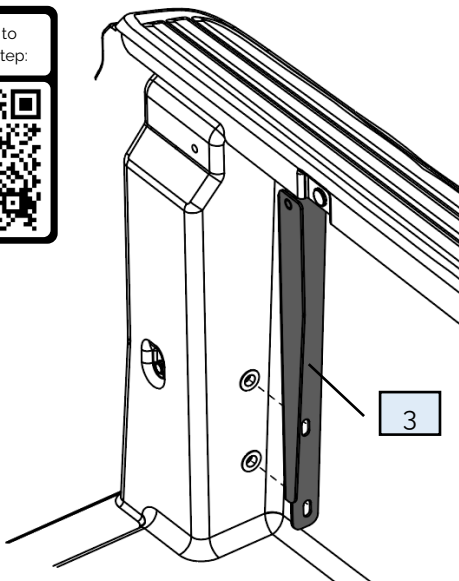

Bolt jamming risk
See Page 2

Install the rear mounting brackets PRT-005465 into the rear corners.

Bolt in place using the original hook and bolts (U).

Repeat for opposite side.

27

Scan here to watch this step:

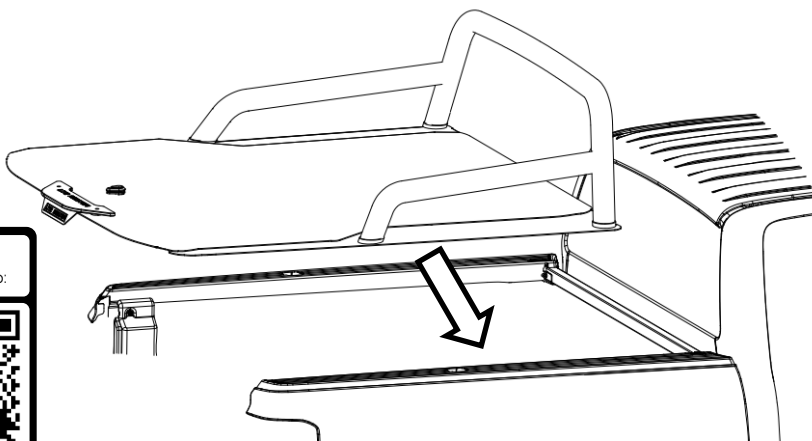

Lift Load-Lid onto the vehicle.

28

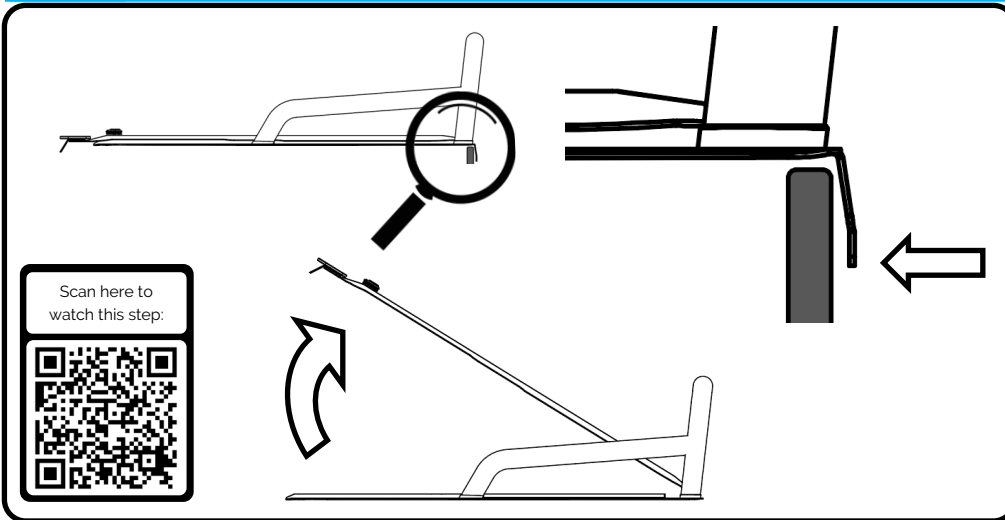

Ensure the Load-Lid is pulled backwards until the front flange touches the front face of the tray.

Open the Load-Lid, ensure it doesn't shift position.

29

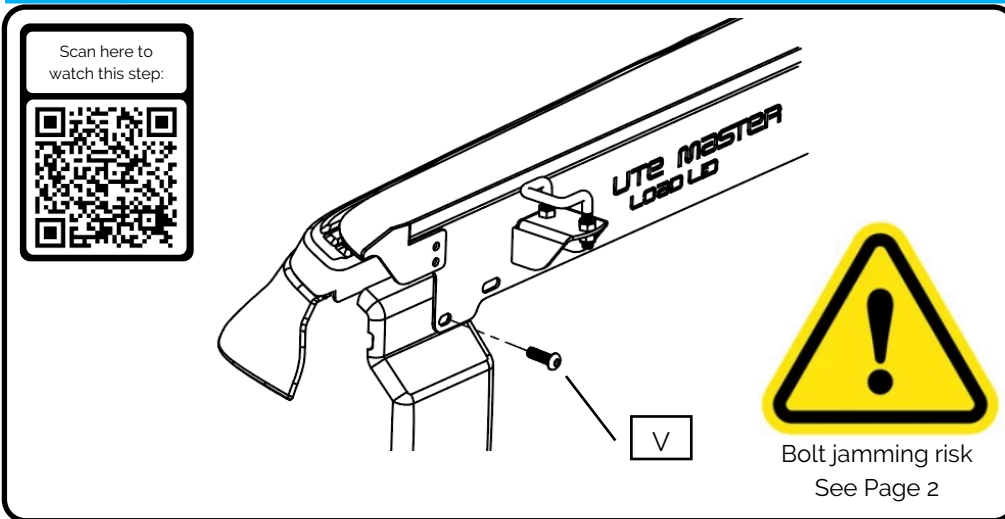

Insert the original bolt from Step 25 (V) through the mounting frame into the vehicle thread.

Note: If there was no bolt removed in Step 15, use the following:

15) M6 x 20mm Btn Bolt

30

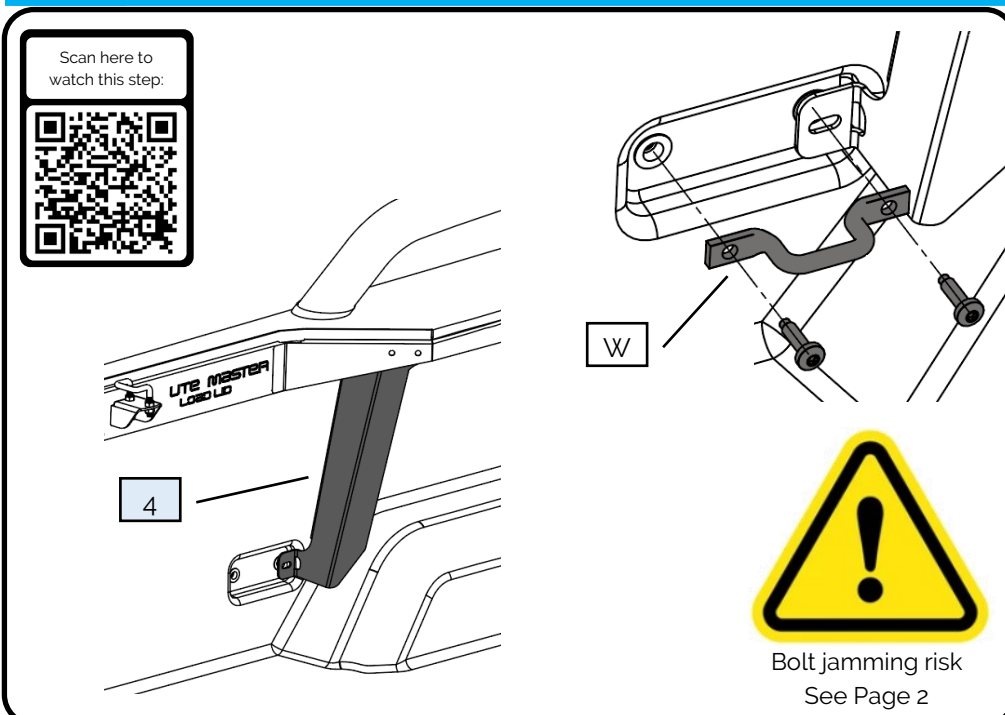

Install the centre mounting brackets PRT-005480-03 to the centre threads using the original hook and bolts (W).

Repeat for opposite side.

31

Scan here to watch this step:

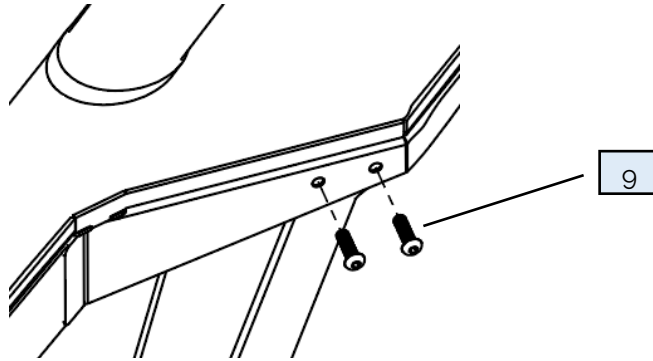

Bolt the centre bracket to the Load-Lid using the following fasteners:

- 9) M8 x 16mm Btn Bolt (Black)
- 14) M8 Nyloc Nut

Repeat for opposite side.

32

Scan here to watch this step:

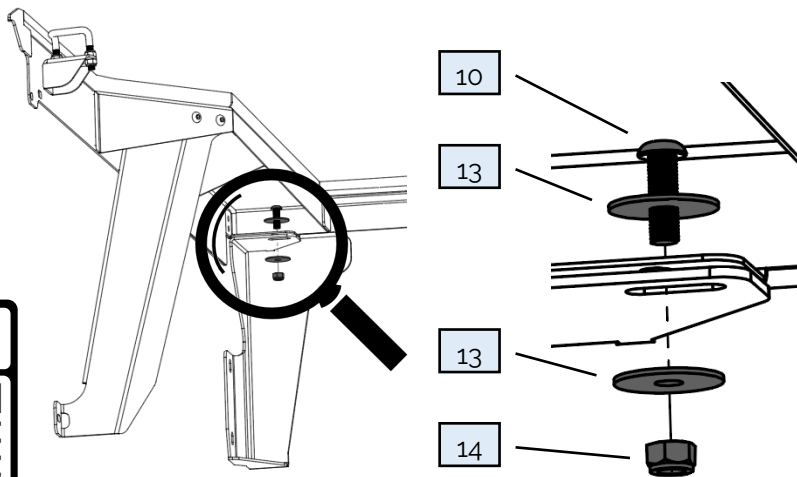

Bolt through the front corner of the Load-Lid into the front mounting bracket, using the following fasteners:

- 10) M8 x 25mm Btn Bolt
- 13) M8 Fender Washer
- 14) M8 Nyloc Nut

Tighten until the Load-Lid pulls down hard onto the tray.

Repeat for opposite side.

33

Scan here to watch this step:

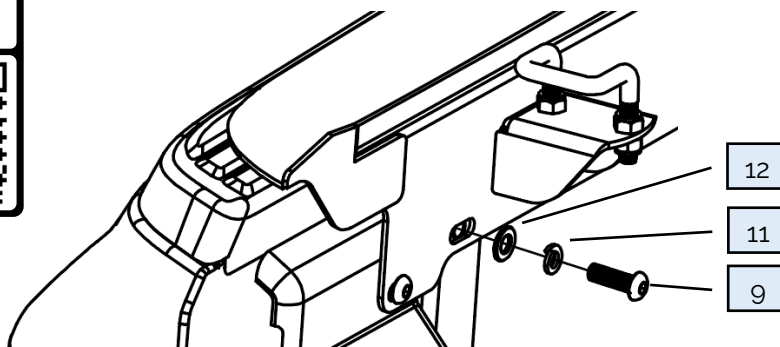

Bolt through the mounting frame into the rear mounting brackets using the following fasteners:

- 9) M8 x 16mm Btn Bolt (Black)
- 11) M8 Spring Washer
- 12) M8 Medium Washer

Repeat for opposite side.

If the Load-Lid is using the Genuine Accessory Ford sports bars, skip to Step 36

34

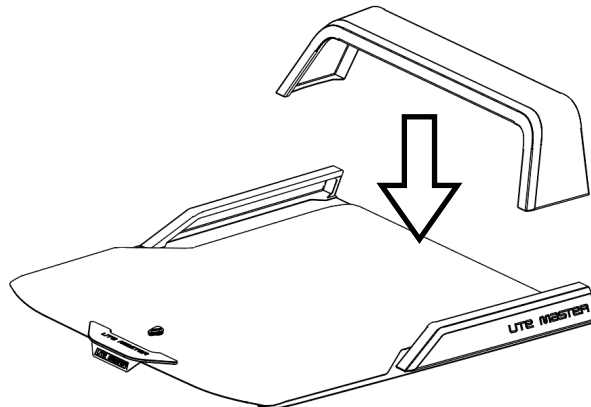

Lift the top hoop of the sailplane onto the Load-Lid.

35

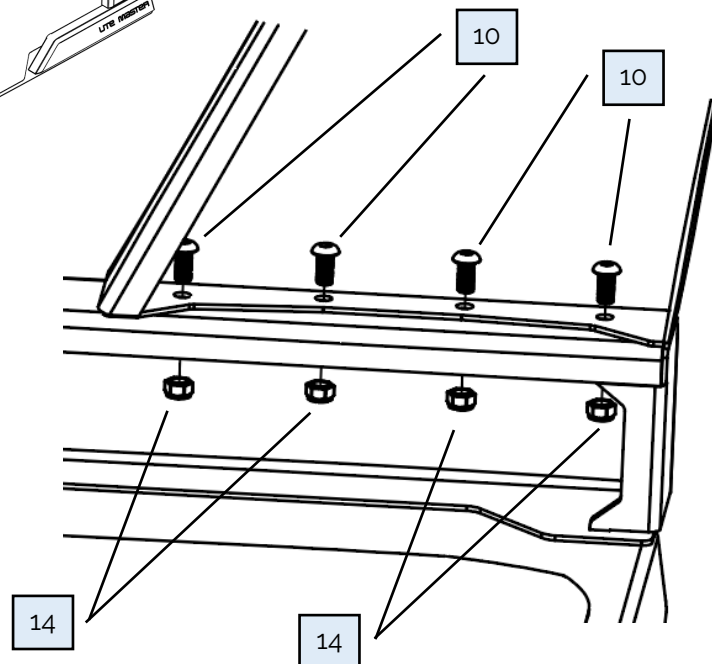
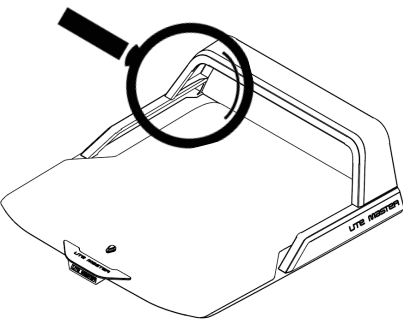

Bolt the top hoop of the sailplane to the base feet on each side, using the following fasteners:

- 10) M8 x 25mm Btn Bolts
- 14) M8 Nyloc Nuts

36



<https://wi.st/2Bp7XJ9>

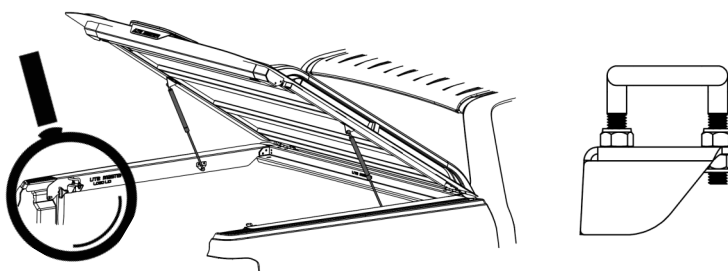

Adjust the nuts on the lock strike to affect the final closing height of the Load-Lid.

Refer to the video on the